

NORTHUMBERLAND COUNTY

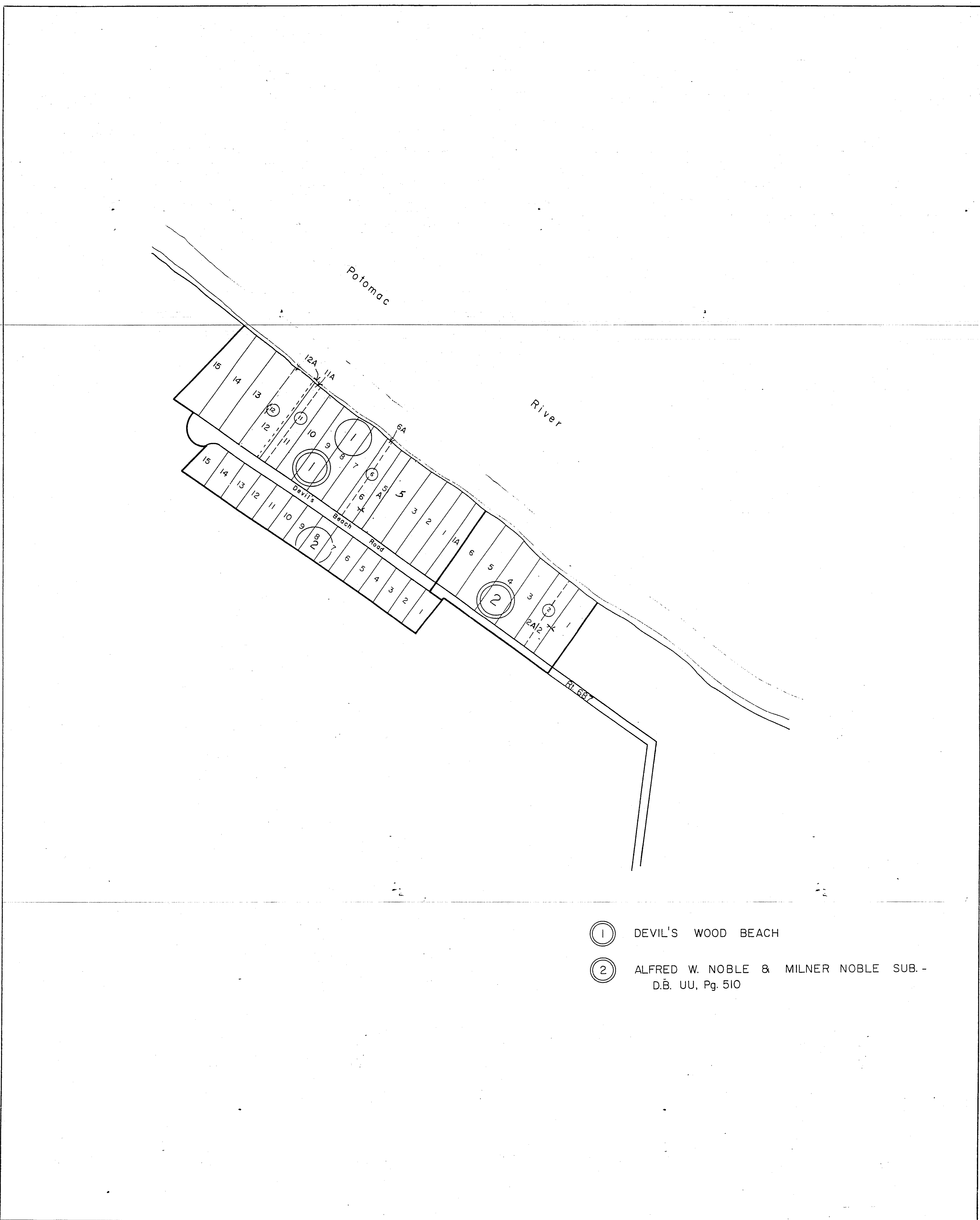

- ① DEVIL'S WOOD BEACH
- ② ALFRED W. NOBLE & MILNER NOBLE SUB. -  
D.B. UU, Pg. 510

SCALE IN FEET  
200 0 200 400 600 800

FAIRFIELD DISTRICT

VIRGINIA STATE DEPARTMENT OF TAXATION, DIVISION OF REAL ESTATE APPRAISAL AND MAPPING

SECTION  
INSERT 21A

SED: