

SUPERVISORS

James W. Bram  
Callao, VA 22435  
District I  
Richard F. Haynie  
Heathsville, VA 22473  
District II

James M. Long  
Wicomico Church, VA 22579  
District III

A.C. Fisher, Jr.  
Wicomico Church, VA 22579  
District IV

Charles H. Williams, IV  
Reedville, VA 22539  
District V



COUNTY ADMINISTRATOR

E. Luttrell Tadlock  
Heathsville, VA 22473  
804-580-7666 (Voice)  
804-580-7053 (Fax)  
ltadlock@co.northumberland.va.us

**Northumberland County, Virginia**

**Board of Supervisors**  
P. O. Box 129 • 72 Monument Place  
Heathsville, Virginia 22473

**NORTHUMBERLAND COUNTY  
PERMISSION TO HUNT**

By authority of the Board of Supervisors of Northumberland County, \_\_\_\_\_ is hereby granted permission to engage in hunting activities for the period commencing \_\_\_\_\_ and terminating on \_\_\_\_\_, on those parcels of land owned by the County, specifically described as: 140 acres, Tax Map No. 24 (1) 9, known as the Poor House Tract; 77 acres, Tax Map No. 26 (1) 30, located in Horsehead and 231 acres, Tax Map No. 23 (1) 72 located near Dodlyt. In consideration of the permission herein granted, \_\_\_\_\_, as evidenced by his signature hereby agrees as follows:

1. Compliance with all local, state and federal laws and regulations regarding hunting activities.
2. Acknowledges that the County of Northumberland makes no representations or warranties as to the condition of the properties or their suitability for hunting activities, and he hereby waives any claims for damages resulting from his activities on the premises.
3. Agrees to Indemnify and save harmless the County from any claims for damages to other persons or property resulting from hunting activities on the premises.
4. To be responsible for any damages to the property caused by his hunting activities.
5. **NO ALCOHOL OR DRUGS WILL BE BROUGHT ONTO COUNTY PROPERTY.**

Permission Is Hereby Accepted Upon  
The Terms Contained Herein.

\_\_\_\_\_  
Signature

\_\_\_\_\_  
E. Luttrell Tadlock, County Administrator

Permission granted this \_\_\_\_\_ day of \_\_\_\_\_, 20\_\_\_\_\_.

**Please complete this form and return to County Administration, P.O. Box 129, Heathsville, VA 22473, along with a copy of your driver's license, hunting license, and proof of local residency or ownership of Northumberland County property.**





NORTHUMBERLAND COUNTY

16

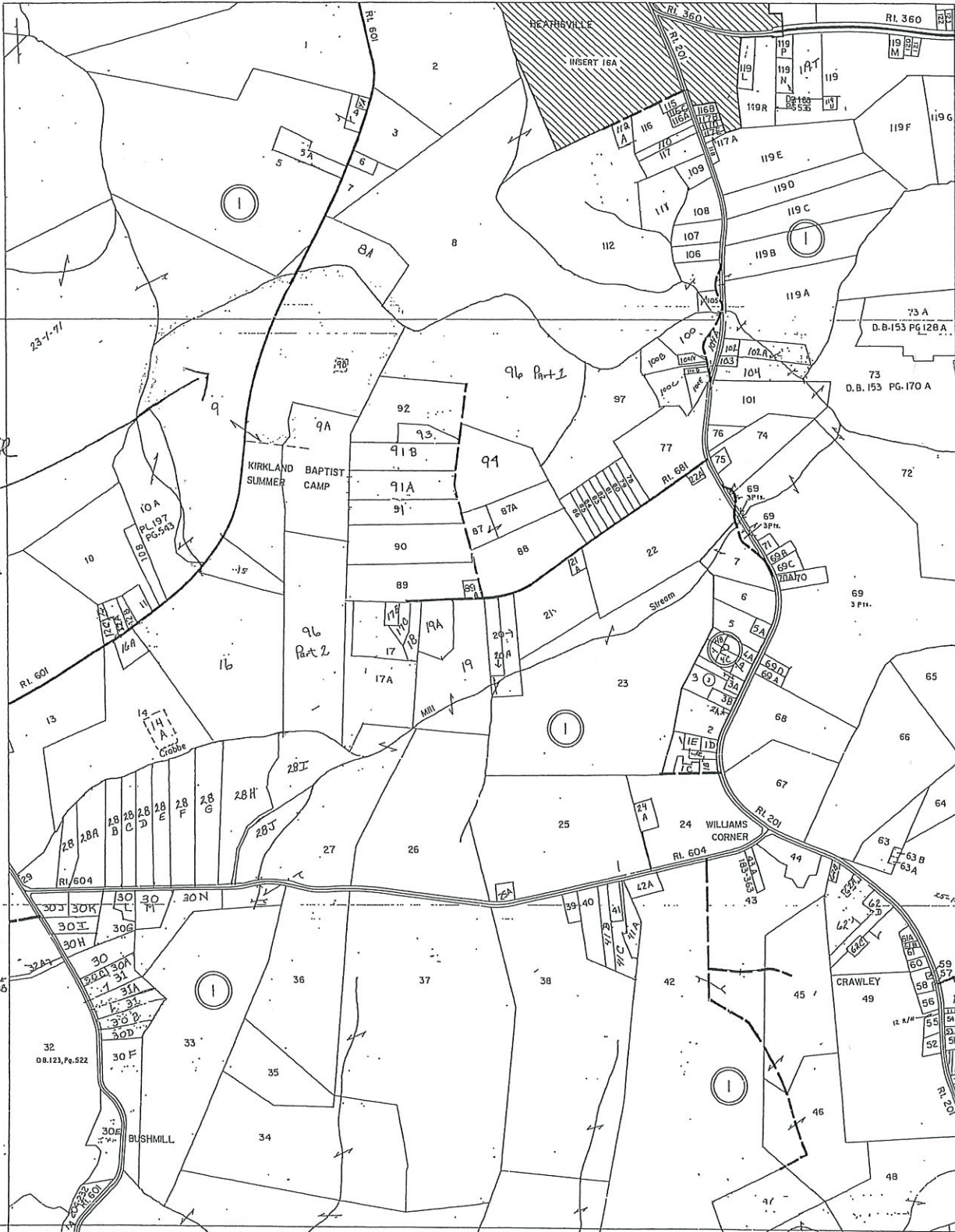

Poor House  
Tract  
See  
permission  
62

HEATHSVILLE DISTRICT

SECTION 24  
INSERT

SCALE IN FEET  
0 100 200 300 400 500

ISED:

NORTHUMBERLAND COUNTY



REVISED.

HEATHSVILLE DISTRICT FAIRFIELD

SECTION 26 INSERT

Virginia State Department of Taxation, Bureau of Real Estate Appraisal and Mapping